

Dearlove Dog Agility

All Breeds & Mixed Breeds Welcome!

Lincolnwood Training Club, Inc., for German Shepherd Dogs



Thursday Nights Starting July 7, 2011—7:00 to 8:00 & 8:00 to 9:00 pm—6-Week Session \$100.00

Enrollment is limited get your application in today!

You learn more about your dog than you ever imaged. It's the ultimate in obedience training without really training. A fun and positive way to bond with your dog. You use various obstacles to learn the in and outs of how to read your dog and how it reads you. There is no pressure with agility, its gentle positive motivational training and a pure joy!

All you need is for your dog to have basic obedience skills. We offer obedience training classes if your dog does not qualify.

Dogs can participate for years as they stay in good shape.

Beginners: This class is for dogs who have had no previous agility training and need to become familiar with the obstacles. Handlers must have on leash control. This class can be repeated.

Advanced Beginners: Start sequencing and handling techniques and directional work who have passed Beginners.

Intermediates: For dogs that are ready for more control exercises, traps and starting off leash control.

Advanced Intermediate: Off leash on advance courses. Must have full off leash control and previous agility experience.

Classes sizes are limited, as such, we reserve the right to select participants best suited for agility training based on prior obedience training and physical condition. Therefore completion of this application is not a guarantee of class acceptance.

For additional information CALL... **847-299-7273**

Location: **Lincolnwood Training Club**

Central and Dearlove Roads in Glenview, Illinois

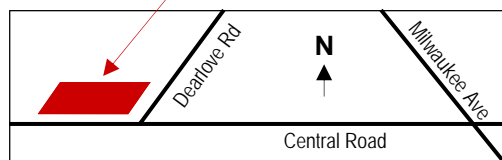

Class Rules:

1. Walk your dog to the "Duty Area" East end of the field prior to class.
2. You are responsible for the behavior of your Dog at all times. Dogs must be on leash when waiting their turn. Aggression toward people or other dogs is not acceptable could be cause for dismissal.
3. Do NOT under any circumstances let your dog urinate on any of the equipment.
4. If there is an accident and your dog potties on any part of the field, immediately clean it up thoroughly, so other dogs don't follow suit.
5. Choke collars and prong collars during agility are not to be used. For safety reasons, flat buckle collars and leashes or loopless tabs are best.
6. Absolutely no abusive behavior toward any dog, handler or instructor will be tolerated.

Bring to Class:

1. Proof of current inoculations
2. Buckle collar & nylon or leather leash
3. Water and dish for drinking
4. Lots of small treats and/or favorite toy

If classes are canceled they will be rescheduled the following week. There are no refunds for missed classes.